

STEP BY STEP GUIDE FOR THE INSTALLATION OF THE SOLIS WIFI STICK



[Watch the Solis Wi-Fi connection video](#)

Solis WiFi stick - quick step guide

Kit includes 1 Wifi stick and 1 user manual

The Solis Wi-Fi card is linked up using a laptop computer or iPhone, this takes just a few minutes.

The Wi-Fi card can only be set-up on site so make sure the monitoring is working before you leave.

1. Connect wifi to the Wi-Fi stick to the interface on the inverter



2. Connect your laptop to the Solis Wi-Fi network - this has a name which looks like "AP-xxxxxxx"



3. Open a web browser and enter "10.10.100.254" into the address bar

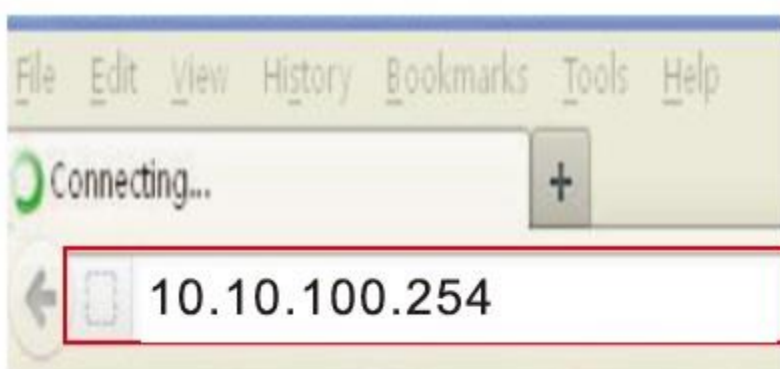

4. Log in to the page , the username is "admin" and the password is also "admin"

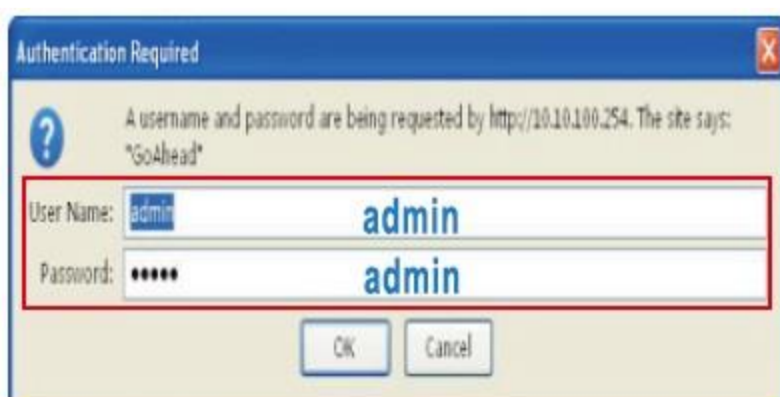

5. Click on "Wizard" and then click "Start"

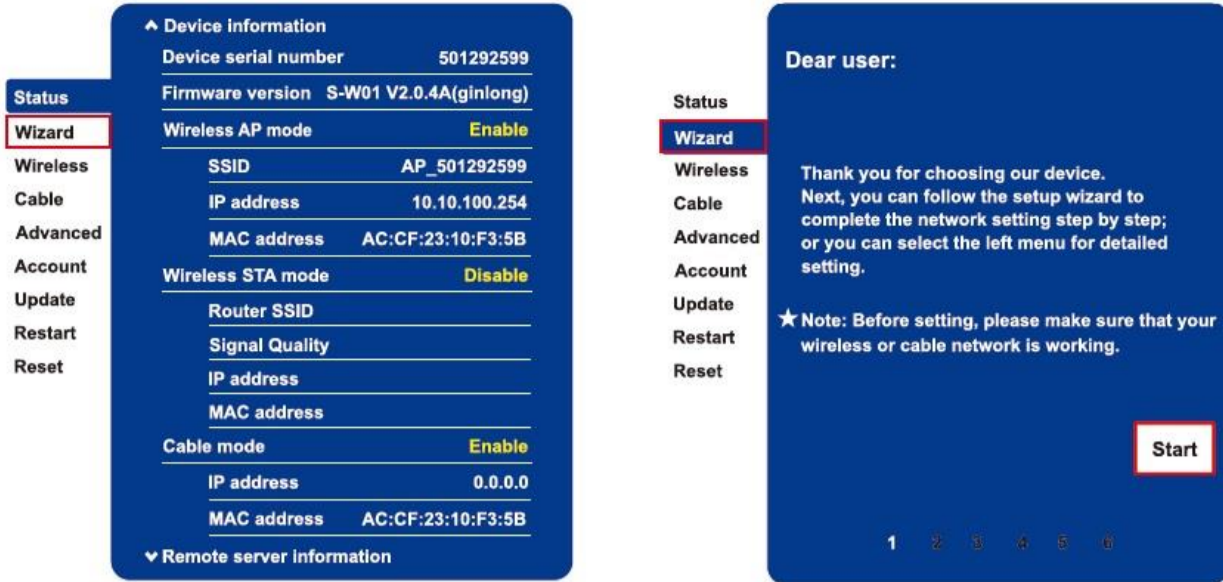

6. Choose "Wireless connection"

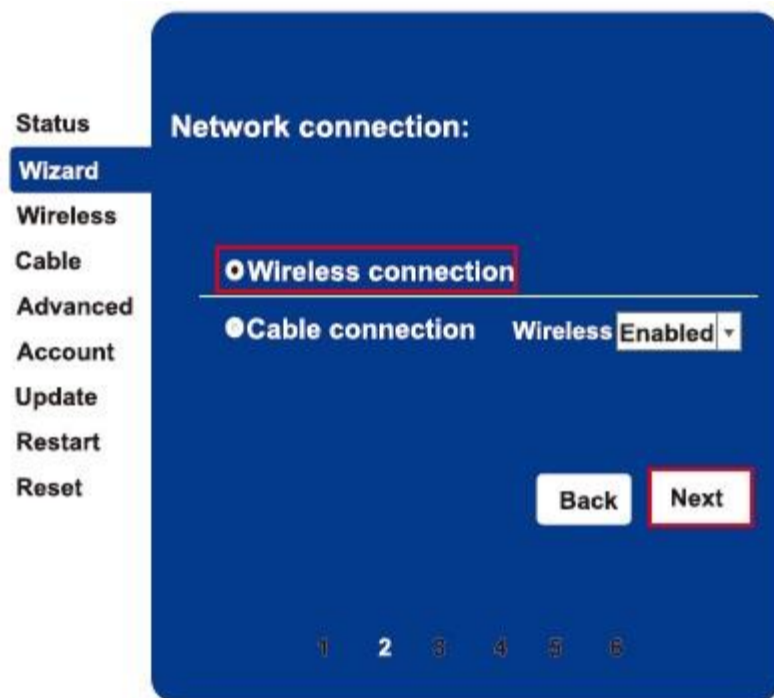

7. Click "Refresh" and then select the customer's home Wi-Fi network from the list of networks.

Check that the "RSSI" connection strength from the Wi-Fi network is at least 10% - if the connection is weak you might need to move the internet router closer to the inverter.

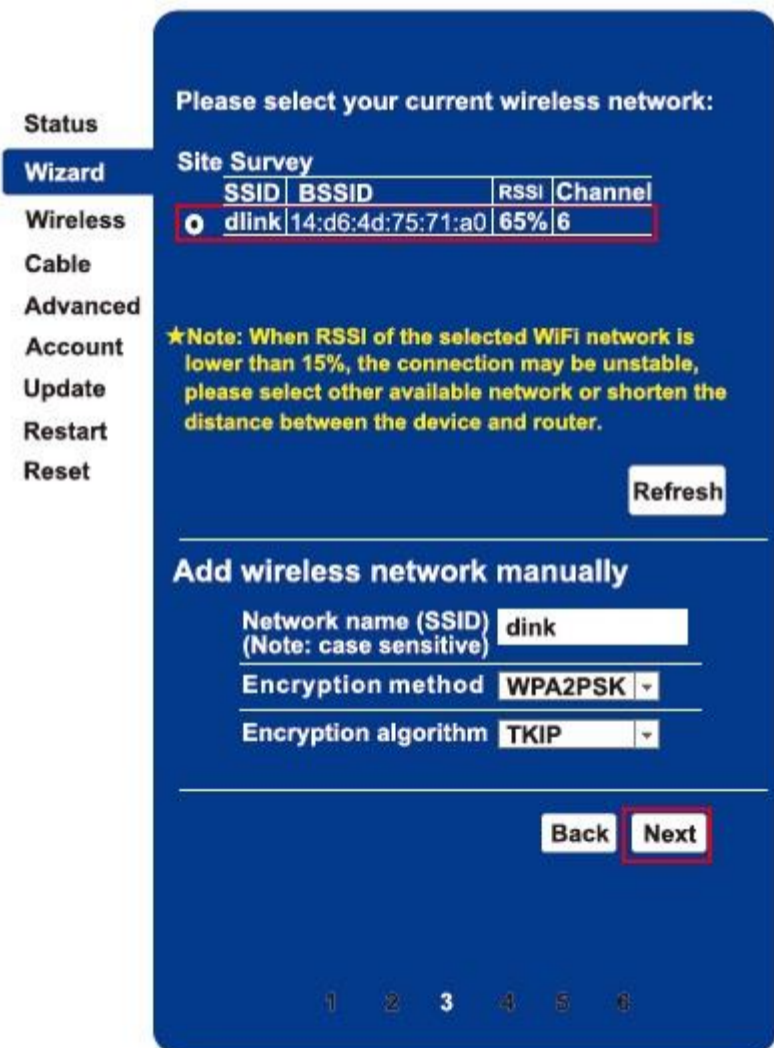

8. Enter the password for the customer's home Wi-Fi network

(this can usually be found printed on the back of their internet router)



9. Choose "Enable" so the IP address is chosen automatically and then click "Next".

10. Connection is complete! Just click "OK" to save the settings.

11. Disconnect your laptop from the Solis Wi-Fi network and re-connect to the customer's home Wi-Fi network

12. Visit www.ginlongmonitoring.com and click "Register" to set up an account for your customer.

13. It can take up to 10 minutes for the data to come online.

Before leaving site log in to your customer's account and make sure you are able to see the data from their inverter online.